

## Island Vent Hood Ceiling Mounting Instructions

1. Remove bottom vent hood panels or vent hood insert
2. Attach ceiling mounted frame to ceiling using appropriate anchors
3. Attach vent hood duct to ceiling duct
4. Attach Venthood to ceiling by inserting frame allthreads through matching holes in vent Hood mounted frame
5. Fasten nuts to all-thread but do not tighten to ceiling
6. Either connect vent hood power cable to J-box in ceiling or bring down customer supplied power cable to venthood junction box on center panel
7. If hood uses a remote blower, then connect blower power cable to remote blower or blower cable in ceiling
8. Tighten vent hood mounting nuts until vent hood is snug against ceiling
9. Reinstall Center Panel(s). Connect duct to center panel or multi-panel manifold if needed.
10. If needed, connect power cable/blower cable to switches in center panel junction box
11. Connect side panel down light wires to matching wires from center panel junction box
12. Reinstall side panels
13. Install downlight bezel covers

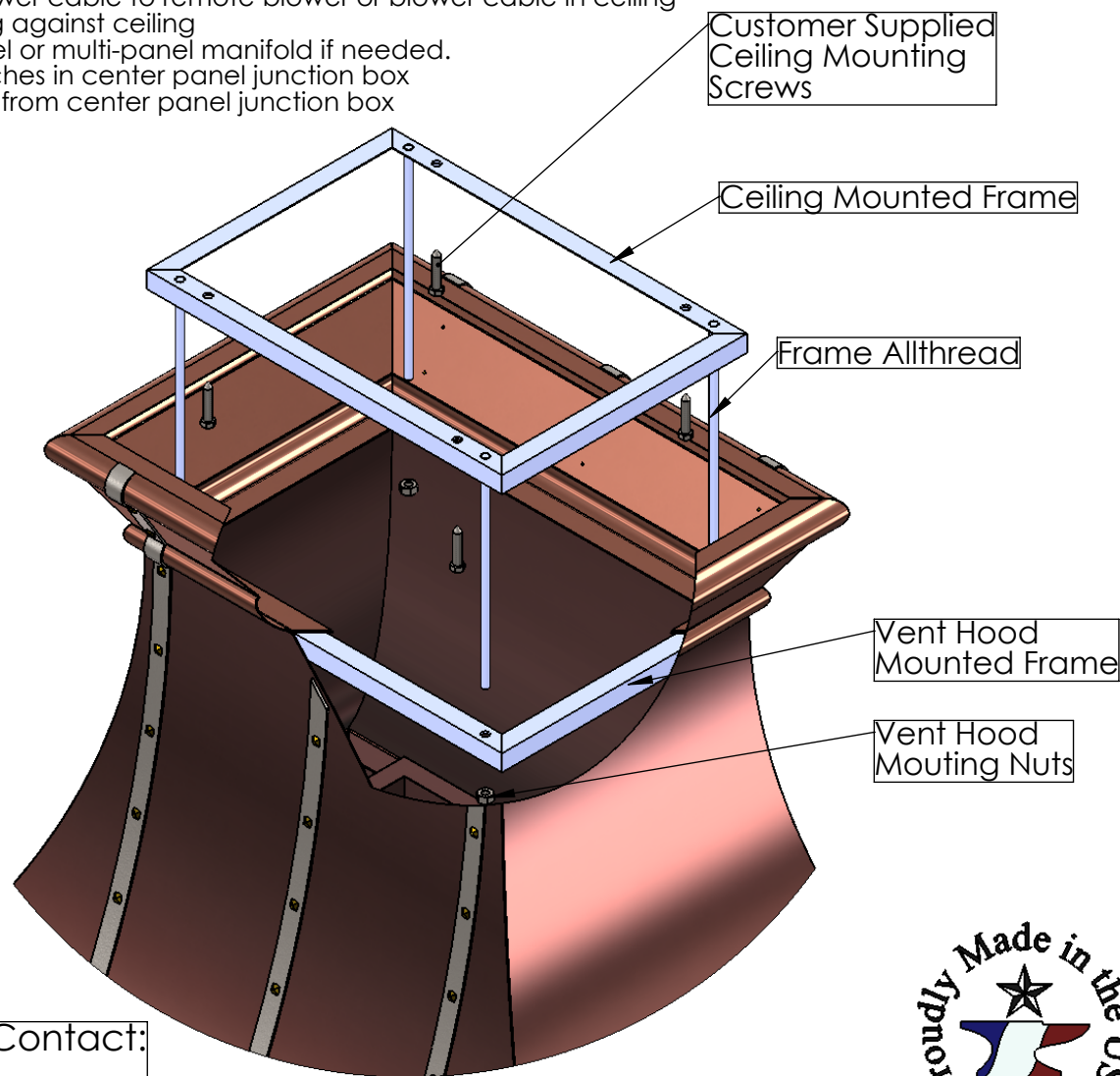
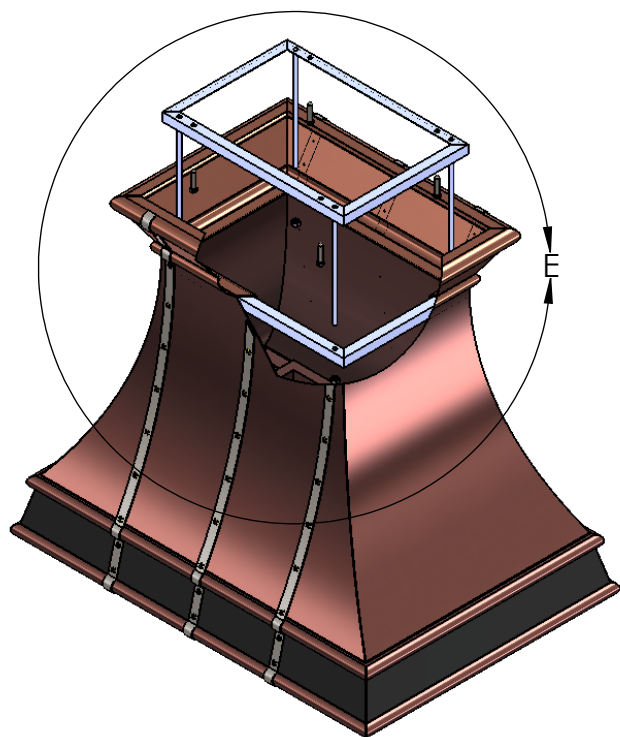

**PROPRIETARY AND CONFIDENTIAL**  
 THE INFORMATION CONTAINED IN THIS  
 DRAWING IS THE SOLE PROPERTY OF  
 Texas Lightsmith. ANY  
 REPRODUCTION IN PART OR AS A WHOLE  
 WITHOUT THE WRITTEN PERMISSION OF  
 Texas Lightsmith IS  
 PROHIBITED.

For Installation Questions Contact:  
 Texas Lightsmith  
 877-268-2266  
[www.texaslightsmith.com](http://www.texaslightsmith.com)

